



TECAPRES®

Ø50mm
1800daN

TPFS 1800.2

VDI SAFETY



MICRO

TITAN

TPH

TPS

TPSP

TPF

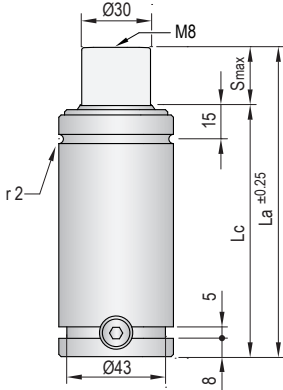

Gas charging G1/8
TPFV5 valve
G1/8 adapter

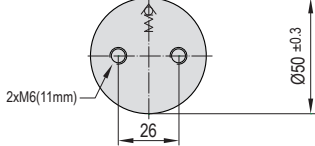

- Pressure medium **Nitrogen (N₂)**
- Max. charging pressure **140 Bar**
- Min. charging pressure **50 Bar**
- Piston seal area **12,57 cm²**
- Operating temperature **0°C - 80°C**
- Force increase by temperature **0,33 %/°C**
- Max. stem speed **25 m/min**
- Maintenance kit **Kit FS1800.2**



Maximum strokes / minute (at 20°C)

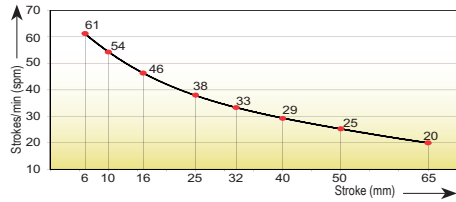

Code	Smax mm	La mm	Lc mm		Fa daN		F daN		Fc daN		P Bar	V l		Kg				
TPFS 1800x6.2	6	66	60	1800 ±5% (20°C)	2400		2400		2555		140 (20°C)	0,025		0,62				
TPFS 1800x10.2	10	80	70												2490	2680	0,038	0,73
TPFS 1800x16.2	16	106	90												2455	2630	0,062	0,85
TPFS 1800x25.2	25	135	110												2545	2750	0,090	0,98
TPFS 1800x32.2	32	162	130												2535	2735	0,116	1,20
TPFS 1800x40.2	40	190	150												2550	2760	0,142	1,25
TPFS 1800x50.2	50	220	170												2605	2835	0,170	1,42
TPFS 1800x65.2	65	271	206												2620	2855	0,218	1,65

Force/stroke ratio

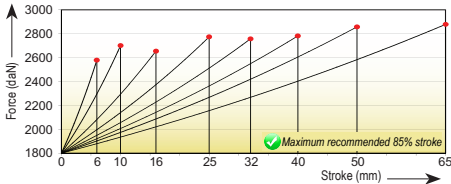

Initial force/charging pressure ratio

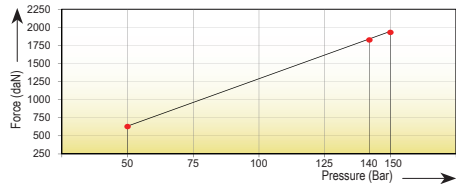

Assembly possibilities



Follow guidelines
Page 287

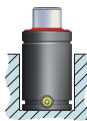

DROP-IN



SCREWS

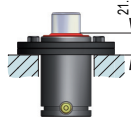

FS 50-FSC 50



FP 50-FPR 50

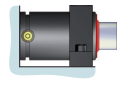

FI 50-FI 50/1